

GENERAL NOTES -
 ** Do not scale from this drawing
 ** Use figured dimensions only
 © This drawing is copyright. No part of this document may be reproduced or transmitted in any form or stored in any retrieval system from the copyright holder, except as agreed for use on a project, for which the document was originally issued.

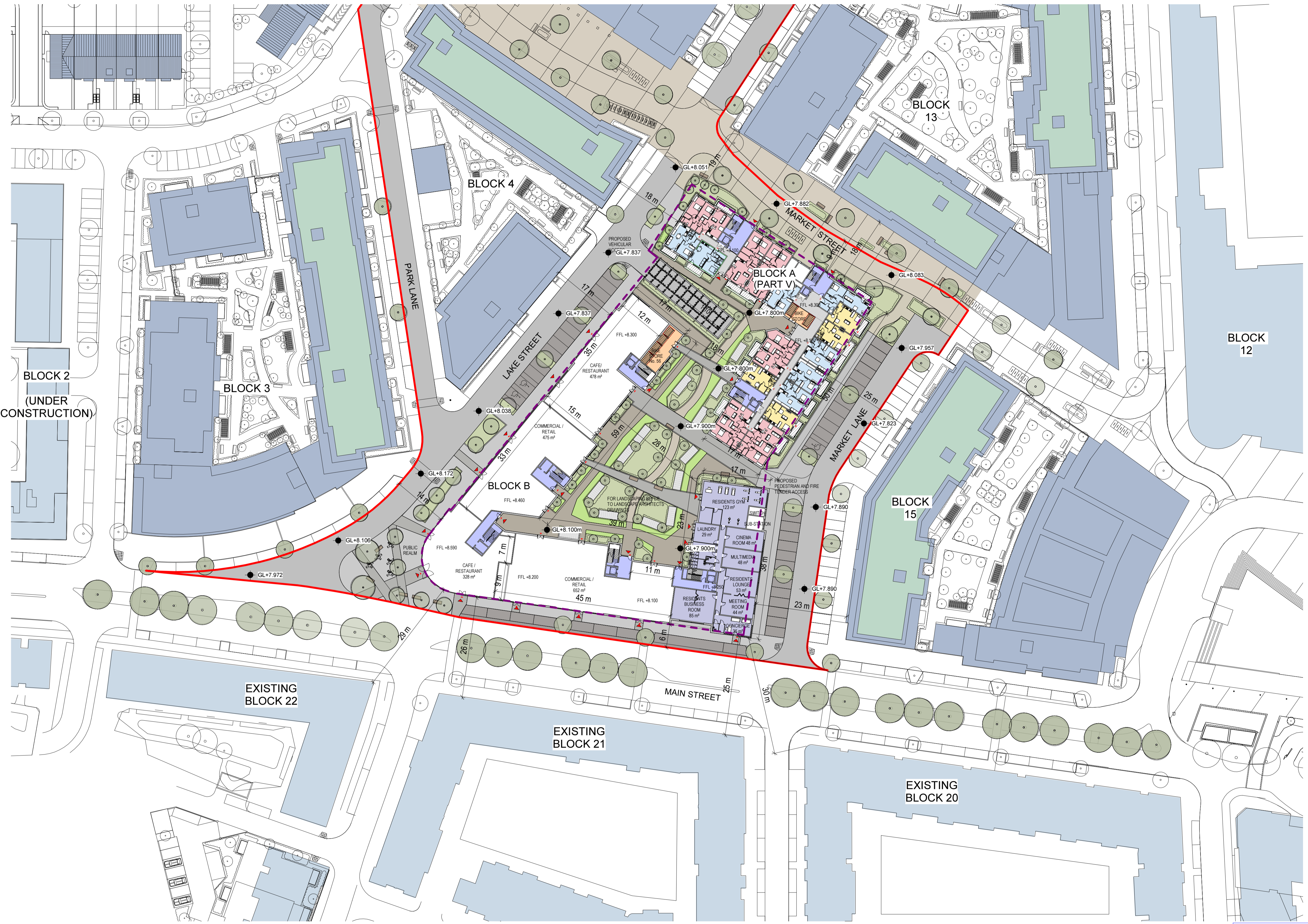
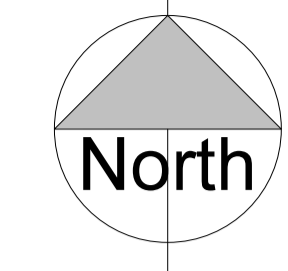

LEGEND:

Includes Ordnance Survey Ireland Data reproduced under OSI Licence Number EN 0073219

SITE OUTLINED RED (2.4936 Hectares)

OUTLINE OF BASEMENT

 STUDIO APARTMENT	4 No.
 1 BED APARTMENT	7 No.
 2 BED APARTMENT	6 No.
 2 No. COMMERCIAL/RETAIL	1127m ²
 2 No. CAFE / RESTAURANT	806m ²
 BTR FACILITIES	745m ²
PUBLIC OPEN SPACE	1977m ²
TOTAL CAR PARKING (SURFACE PARKING)	211
(BASEMENT PARKING)	49
	162
TOTAL BIKE PARKING (ON STREET BIKE PARKING)	651
(BIKE PARKING GROUND FLOOR)	10
(BIKE PARKING BASEMENT)	88
	553

MAP SHEETS
3133-08

BLOCK 14 SITE GROUND FLOOR PLAN
Scale 1 : 500

BLOCK 14A - 6 STOREY

STUDIO	- 4 UNITS
1 BED APARTMENT	- 43 UNITS
2 BED APARTMENT	- 44 UNITS
3 BED APARTMENT	- 6 UNITS
TOTAL BLOCK A	- 97 UNITS

SUMMARY

STUDIO	- 49 UNITS
1 BED APARTMENT	- 106 UNITS
2 BED APARTMENT	- 121 UNITS
3 BED APARTMENT	- 12 UNITS
TOTAL BLOCK 14	- 288 UNITS

BLOCK 14B - 6 - 8 STOREY

STUDIO	- 45 UNITS
1 BED APARTMENT	- 63 UNITS
2 BED APARTMENT	- 77 UNITS
3 BED APARTMENT	- 6 UNITS
TOTAL BLOCK B	- 191 UNITS

SUMMARY COMMERCIAL / RETAIL

CAFE / RESTAURANT (2 UNITS)	- 806 m ²
COMMERCIAL / RETAIL (2 UNITS)	- 1127 m ²
TOTAL COMMERCIAL / RETAIL	- 1933m²
BTR FACILITIES	- 745m²
3.9m ² BTR FACILITIES / UNIT	

BLOCK 14

PLANNING

Rev.	Initial	Date	Revision Description
A	RJ	2018.08.16	ISSUED FOR PLANNING

downey PLANNING & ARCHITECTURE		1 Westland Sq, Pearse Street, Dublin 2, Ireland - Tel +353 (0) 1 253 0220 - www.dpsa.ie
CLIENT	GERARD GANNON PROPERTIES	SCALE @ A1: 1: 500 PAPER SIZE: A1
PROJECT	BLOCK 14, CLONGRIFFIN, DUBLIN 13	SCALE @ A3: 200 NO. 073-021
DWG. TITLE	BLOCK 14 SITE GROUND FLOOR PLAN	CHECKED BY: JH DATE: AUG 2019 DRW NO: PL-003